



# Original Instruction

## SCK-5300



[www.facebook.com/denverelectronics](https://www.facebook.com/denverelectronics)

Before operating this electric kids scooter, parents/adult supervisors must read all the instructions for safe assembly, operations and maintenance. User's manual can guide you through the functions and usage of the electric kids scooter. Before using this electric kids scooter, familiarize yourself with how to operate, so that you can keep the electric kids scooter in the best condition possible.

**Warning!**

This appliance can be used by children aged from 8 years and above and persons with reduced physical, sensory or mental capabilities or lack of experience and knowledge if they have been given supervision or instruction concerning use of the appliance in a safe way and understand the hazards involved. Children shall not play with the appliance. Cleaning and user maintenance shall not be made by children without supervision.

## Chapter 1 **General information**

We urge owners of this electric kids scooter model to charge and store it in a safe place. To increase the safety and life of the batteries associated with this model it is important not to charge this model if the temperature is below 5°C or above 45°C. In addition, the charger must be disconnected when the battery is fully charged. Only use the supplied charger (HLT-118B-2520900E).

We do not recommend kids under 6 years of age to ride this electric kids scooter.

### **WARNING:**

To avoid serious injury:

#### **PARENTAL AND ADULT RESPONSIBILITY AND SUPERVISION ARE NECESSARY.**

Riding this electric kids scooter can be hazardous. Parents and supervising adults need to select the riding products which are appropriate for their child's age to avoid children are too immature or inexperienced to endanger themselves.

Parents/supervising adults must assemble the product and make sure the product is working well before they let the children use the product.

Parents/supervising adults must teach children how to safely ride this electric scooter. Always pay attention to where the children are going.

Cleaning and maintenance shall not be made by children, only by parents or supervising adults. Please make sure to cover the charging input to avoid electrical problems. Always disconnect the product from charger prior to wiping it down or cleaning it with a damp cloth. Only clean the scooter with a damp cloth. Do not use running water or a pressured water-gun. Do not clean with alcohol, gas, kerosene or other corrosive and volatile chemical solvents.

Do not immerse the product in water.

Store the product in a dry and cool place when not use it. Defectives caused by storing or using the electric kids scooter in wet/humid places are not covered by the warranty.

Do not leave the device exposed to sunlight in a car.

### 1.1 **The risk of driving**

#### **WARNING:**

- Learn how to drive safely before you drive fast on the electric kids scooter.
- Do not make dangerous moves or one-handed rides while the scooter is running. Keep your feet on the foot pedal.
- Falling, losing control, crashing, including violating the rules in the user's manual can lead to injury.
- Speed and range may differ based on rider's weight, terrain, temperature, and driving style.
- Make sure to wear helmet, protective clothing, kneepads and elbow pads before using the electric kids scooter to avoid serious injury.



- Do not wear loose clothing or open laces that can be caught in the wheels.
- Make sure to read the manual carefully before using the electric kids scooter.
- Only for use in dry weather. Don't ride in rain, snow or moist areas.
- When encountering rough or uneven road conditions, please slow down or get off the scooter.
- Do not try to directly pass steps exceeding 3 cm. It may cause the scooter to subvert, causing the rider to be injured or the scooter to be damaged.
- This electric kids scooter is for domestic use only. Direct parental/adult supervision is required at all times. Only use the product in controlled environments free of potential traffic hazards and do not use it on public streets.
- Do not use this product if the temperature is below  $-5^{\circ}\text{C}$ .
- Do not use it in a sloping section over 5 degrees. For use over 5 degrees uphill, you need to assist with your foot.

**Please note:**

The manufacturer accepts no liability for improper use of this product.

## 1.2 The preparation before operation

Before using, the battery should be fully charged. Please check Chapter 2.3.

## 1.3 The weight limitation of the operator

The reason of the weight limitation:

1. guarantee the safety of the operator
2. avoid overloading which can make motor defective.

Maximum load: 50kg.

**Defective motor caused by overloading will not be covered by the warranty.**

## Chapter 2 **Operating the Electric kids scooter**

### 2.1 **Folding procedure**

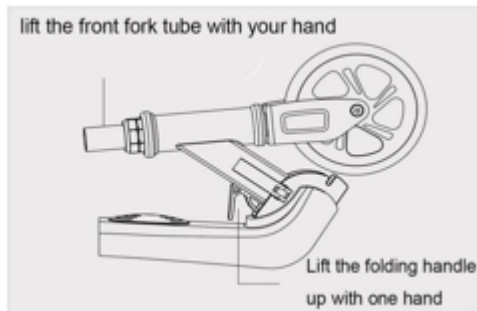

Lift the folding handle up with one hand and lift the front fork tube with the other hand and you hear a "click".



Press the folding lock firmly (the folding lock can adjust the tightness).

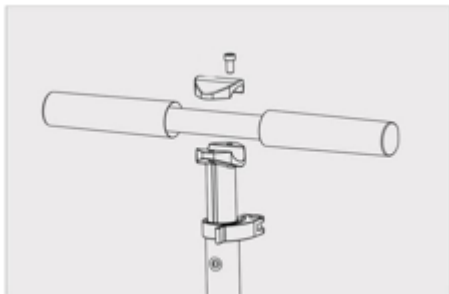

Use the screwdriver to lock the handle block.

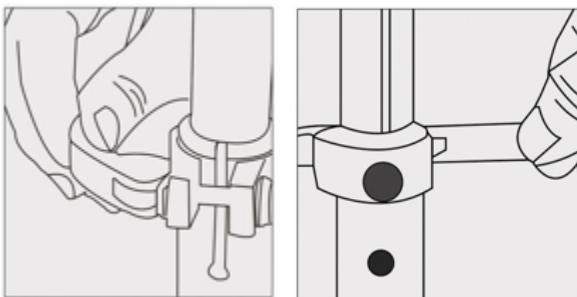

Make sure that the buckle is released.

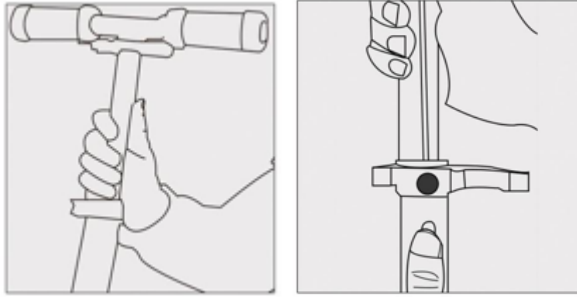

Press adjustment marble with one hand and adjust the telescopic rod to the proper position with the other hand. Users must adjust the height of the product to the proper position to ensure safe driving.

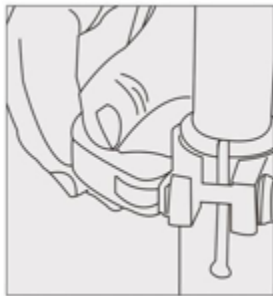

Tighten and lock the buckle.

## 2.2 Using the scooter

Start using the electric kids scooter.

1. Hold the handle with both hands and place one foot on the round power pedal and keep it there.

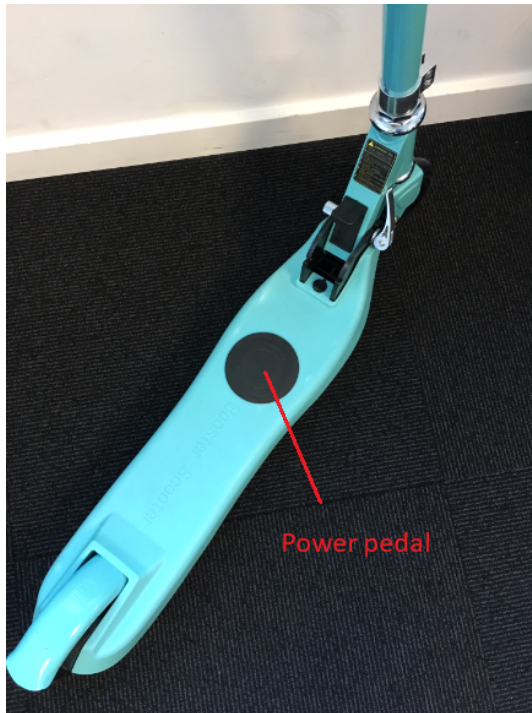

2. Gently push forward with the other foot. When you reach 5-6 km/h then the motor will make a BEEP and the engine starts.
3. Now the electric kids scooter drives itself and will maintain a speed of 4-6km/h dependent on the surface.
4. If you want to stop the motor again you just step off the power pedal.
5. If you want to slow down then step lightly on the rear mechanical brake.



6. If you want to stop. Please use one foot to step on the rear mechanical brake. After hearing the BEEP, then continue to step on the brake until the electric kids scooter stops.
7. If the scooter gives a continuous series of “beeps”, the battery is low. Please charge the scooter.

## 2.3 Charging the scooter

This chapter mainly discusses the charging methods, battery maintenance, safety issues and battery specifications. For safety of yourself and others, and extending the battery's life and improving battery performance, please make sure to follow the following operations. If the product is not used for a long period of time, be sure to charge it once a month to protect the battery life. Charger should only be operated by an adult. It is not a toy.

**Note: If the battery is damaged due to water, collision and other abnormal usage, it is not covered by the warranty.**

### Low battery

If the electric kids scooter gives a continuous series of “beeps”, the battery is low. Please stop riding and charge immediately after the scooter emits a low battery warning tone to avoid damage to the battery or affect your use.

### Charging the battery

1. Only use the supplied and dedicated charger (HLT-118B-2520900E).
2. Open the charging rubber cover on the pedal and insert the charger output connector into the charging hole.

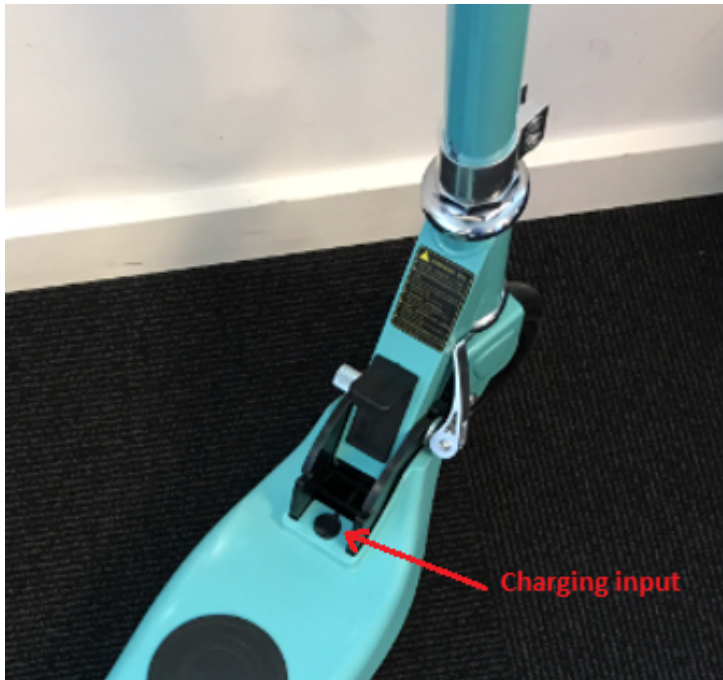

3. Plug the charger input power into the power socket.
4. The charger indicator is red, indicating that it is charging. When the charger indicator turns green, the battery is fully charged and after approximately 30 mins the adapter will stop charging.
5. When the charging is finished, unplug the battery charger from the mains power supply and from the electric kids scooter and close the charging rubber cover again.
6. The electric kids scooter is ready for use.

## **WARNING:**

Do not charge the battery or use the product in the following cases.

- Giving out some odor or excessive heat.
- Leakage of any substance.

## **WARNING:**

- Do not ride the electric kids scooter when charging!
- It is prohibited to disassemble the battery.
- Do not touch any substance leaking out of the battery.
- Do not let children and animals touch the battery.
- Batteries contain dangerous substances inside. It is forbidden to open the battery and stick objects into the battery.
- Use only the supplied charger (HLT-118B-2520900E).
- Don't over charge or discharge the battery.

## **WARNING:**

Lithium battery inside!

### **Regarding battery charging**

**Important – Please read!**

Dear customer. We hope you get a lot of joy out of your new kids scooter.

The battery in these kinds of scooters is not fully charged from production line to avoid slow charge or damage. When left unused, the battery will slowly discharge.

If you cannot turn on your kids scooter, and it doesn't seem to charge (the charger light up green instantly), then please do the following.

1. Leave the charger in for 6-7 hours. This will make sure the battery will be fully charged again (it can take 3-4 hours before it starts normal charging).
2. If this does not solve your problem, please ride the kids scooter manually without turning it on. Use your legs to give speed, for around 100 m, and then connect



the charger. The engine in the rear wheel will this way help to activate the charging function and it will charge normally. (fully charge takes 2 hours if using this way)

Please enter: [www.denver-electronics.com](http://www.denver-electronics.com) to obtain the electronic version of the manual.

<b>Parameters</b>	
<b>Model</b>	<b>SCK-5300</b>
<b>Color</b>	<b>Black, White, Blue, Pink</b>
<b>Speed</b>	<b>4-6km/h</b>
<b>Maximum grade</b>	<b>About 5°</b>
<b>Maximum running distance</b>	<b>6km</b>
<b>Battery</b>	<b>Type: Li-ion battery Nominal voltage (V): 21.6V Voltage (V): 25.2V Battery capacity: 2000mAh</b>
<b>Ride condition</b>	<b>Not recommended for kids below 6 years of age Ride load less than 50kg</b>
<b>Charger</b>	<b>Rated input voltage (V): 100V - 240V AC Rated output voltage (V): 25.2V Rated current (A): 0.9 A</b>
<b>Charging Time</b>	<b>About 2.0h</b>
<b>Motor power</b>	<b>100W</b>
<b>Front Wheel</b>	<b>145mm PU Wheel</b>
<b>Braking method</b>	<b>Manual brake on back wheel.</b>
<b>Low battery protection</b>	<b>Will sound "Beep, beep, beep" when power is 15%</b>

Please notice - All products are subject to change without any notice. We take reservations for errors and omissions in the manual.

ALL RIGHTS RESERVED, COPYRIGHT DENVER ELECTRONICS A/S

# DENVER®

[www.denver-electronics.com](http://www.denver-electronics.com)



Electric and electronic equipment and included batteries contains materials, components and substances that can be hazardous to your health and the environment, if the waste material (discarded electric and electronic equipment and batteries) is not handled correctly.

Electric and electronic equipment and batteries is marked with the crossed out trash can symbol, seen below. This symbol signifies that electric and electronic equipment and batteries should not be disposed of with other household waste, but should be disposed of separately.

As the end user it is important that you submit your used batteries to the appropriate and designated facility. In this manner you make sure that the batteries are recycled in accordance with legislature and will not harm the environment.

All cities have established collection points, where electric and electronic equipment and batteries can either be submitted free of charge at recycling stations and other collection sites, or be collected from the households. Additional information is available at the technical department of your city.

DENVER ELECTRONICS A/S

Omega 5A, Soefte

DK-8382 Hinnerup

Denmark

[www.facebook.com/denverelectronics](https://www.facebook.com/denverelectronics)

## WARNINGS

**Please read the manual completely and the instructions below before using the product.**

Product names: DENVER SCK-5300



Product type: Electric Kids kick scooter

Year of manufacturing: 2019

- Note: ONLY use the supplied charger labelled HLT-118B-XXXYYYYZ with the following output voltage to charge this balance scooter: 21.6V - 2A.
- Using another charger may damage the product or create other potential risks.
- Never charge the product without supervision.
- The charging period of the product should not exceed three hours. Stop charging after three hours.
- The product should only be charged in temperatures between 0°C and 45°C.
- If charging at lower or higher temperatures, there is a risk that the performance of the battery will be reduced and a potential risk of damage to the product and personal injury.
- The product should only be used in temperatures between -10°C and +45°C.
- If used at lower or higher temperatures, there is a risk that the performance of the battery will be reduced and a potential risk of damage to the product and personal injury
- Store the product at temperatures between 0°C and 35°C. (optimum storage temperature is 25°C)
- Charge and store the product in an open, dry area and away from flammable materials (i.e. materials that may burst into flames).
- Do not charge in sunlight or near open fire.
- Do not charge the product immediately after use. Let the product cool down for one hour before charging.
- If the product is left with other persons for example during a holiday period, it should be partially charged (20-50% charged). Not fully charged.
- Do not remove the product from the packaging, charge it fully and then put it back into the packaging.
- When shipped from the factory, the product has often been partially charged. Keep the product in a partially charged state, until it is going to be used.

Inter Sales A/S

Omega 5A, Soeften

DK-8382 Hinnerup

Denmark

[www.denver-electronics.com](http://www.denver-electronics.com)

## EC Declaration of Conformity (Machine Directive)

The undersigned

**Company Name:** DENVER ELECTRONICS A/S  
**Address:** Omega 5A, Soeften, 8382 Hinnerup, Denmark

Certifies that the design and manufacturing of this product

**Product Name:** Brand DENVER  
**Product Model No.:** DENVER SCK-5300  
**Product Type:** Electric Kids kick scooter  
**Year of Fabrication:** 2019

Confirms to the following directives: **Machine directive 2006/42/EC**

**MD Standards:** EN ISO 12100:2010 Annex1 of 2006/42/EC, EN 60335-1:2012+A11:2014+A13:2017

and therefore complies with the essential requirements of the Machine Directive.

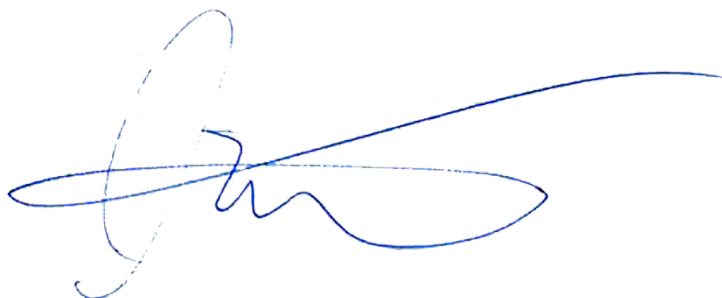

The identity and signature of the person empowered to draw up the declaration and compile the technical files on behalf of the manufacturer:

**Signature:** \_\_\_\_\_  
**Full Name:** Alfred Blank  
**Position:** CEO  
**Company:** DENVER ELECTRONICS A/S  
**Date:** 3rd March 2019

