

DENVER[®]

Instruction Manual

Clock Radio

CRL-341



www.facebook.com/denverelectronics

www.denver-electronics.com

Before operating this product, please read this instruction manual carefully and completely.

1. Function

- 1.1 Led time display in 12H-24H format
- 1.2 White and color light
- 1.3 Sunrise simulation wake up light
- 1.4 Sunset simulation sleep light
- 1.5 Touch mode
- 1.6 Wake up to natural sounds or FM radio
- 1.7 FM Radio and antenna built in
- 1.8 Power supply: DC 5V, 1 x CR2032 battery, or USB cable

2. Diagram

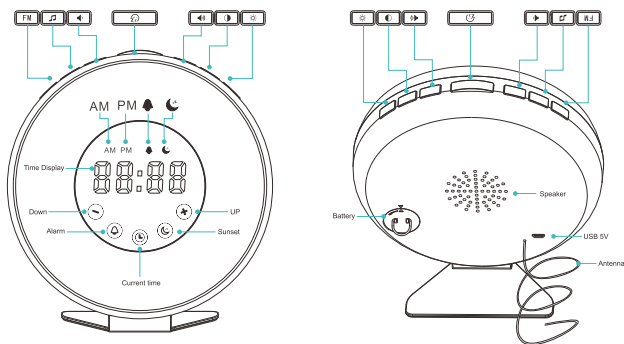

EN	EN
Time display	Time display
Down	Down
Alarm	Alarm
Current time	Current time
Sunset	Sunset
Up	Up
Battery	Battery
Speaker	Speaker
USB 5V	USB 5V
Antenna	Antenna

3. Operation

3.1 Place the Wake-up Light 16-20in/40-50cm from your head, for example on a bedside table.

3.2 Power

- 3.2.1. Connect with DC 5V USB power and insert 1xCR2032 battery. Note that the battery is for backup only. Please notice, the battery backup will only keep your time and alarm settings. The clock radio cannot be operated, show the time, nor will it sound the alarm when no 230V connection is on.

3.3 Setting the clock time

- 3.3.1. When you plug in the light for the first time, or when there has been a power failure, the clock display will flash and you have to set the time. Use the \ominus/\oplus buttons to set the hour and press the \odot button to confirm. Repeat to set the minutes.
- 3.3.2. To adjust the time displayed, press and hold the \odot button for 3 sec until the hour display starts to flash. Use the \ominus/\oplus buttons to set the hour and press the \odot button to confirm. Repeat to set the minutes. The display will exit the setting mode if no buttons are pressed for 10 seconds.
- 3.3.3. When the time is set, press the \odot button to switch between the 12H and 24H modes. In the 12H mode, AM or PM will be displayed.
- 3.3.4. Press the \bullet button to set the LED display intensity (Low-High-Off). When the light is plugged in for the first time, the intensity is automatically set to high. If it is set to low intensity, it will automatically change to high intensity when you change any settings, and then revert back to low intensity after 5 seconds.

3.4 Light

- 3.4.1. Press the \odot button to switch on the light and use \ominus/\oplus buttons to set the brightness from 1 to 10.
- 3.4.2. Pressing the \odot button for a second time will enter the color-setting mode. Use the \ominus/\oplus buttons to select color: Green, Red, Blue, Purple, Orange and Indigo.
- Pressing the \odot button for the third time will switch the light off

3.5 Setting the alarm wake-up time and sound



- 3.5.1. Press the \triangle button to switch the alarm mode on or off. The \triangle symbol will be displayed when the alarm is on. When you switch the alarm on, the alarm time will be displayed for 2 seconds.
- 3.5.2. Press and hold the \triangle button for 3 sec to set the alarm time. The hours indication will start to flash. Use the \ominus/\oplus button to set the hour and press the \triangle button to confirm. Repeat to set the minutes. The display will exit the setting mode if no buttons are pressed for 5 seconds.
- 3.5.3. Wake-up sound
- Press the 🎵 button to set the wake-up sound. Use the \ominus/\oplus button to select the sound you want (1-7). Each sound (1-6) will play for 60 sec when selected. Sound 7 is the FM radio. Press the 🎵 button to confirm your choice.
- Press the $\text{🔊}/\text{🔊}$ button to set the alarm volume (00-15).

3.6 Sunrise light simulation

30 minutes before the alarm time, the light will come on and gradually increase brightness. At the alarm time, the wake-up sound or radio will play for 5 minutes.

While the sound is playing, you may:



- Press or touch any button except 🔊 to stop the sound and light.

- Pressing the  button will stop the light and sound for 5 minutes. The sound will then start playing again and the light will come on and increase in intensity for 5 minutes.
- Hold the  button for 3 sec to switch off the light.

If the FM radio is playing at the alarm time, it will switch off and the wake-up light sound will play. When the wake-up sound stops, the radio will resume playing.

3.7 Sunset light simulation

3.7.1. Touch the  button to set the sunset light simulation. 15 will be displayed. Pressing the button repeatedly will display 15/30/60/OFF. The numbers represent the time in minutes that the light will take to dim. When the desired number is displayed, don't press any button for 5 sec. This will set the sunset time and normal operation will resume.

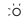
3.7.2. During sunset simulation, the  indicator will flash. Press the  button to cancel the sunset simulation and keep the current brightness. Press the  button for 3 sec to switch off the sunset light.

3.7.3. If FM radio is playing during sunset, the radio will be switched off together with the sunset light.

3.8 FM radio

3.8.1. Press the **FM** button to turn the radio on or off. Hold the **FM** button for 3 sec to scan and save available FM channels.

Press the  button to select a FM station.

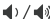
Press the  button to set the radio volume (00-15).

3.9 Safety Guidelines

- The battery is only used for setting backup.
- Don't immerse the light in water or any other liquid.
- Don't throw the light in a fire.
- Don't press more than one key at the same time.
- For the button function to work properly, buttons should be pressed for at least 1 second.
- In the event that the unit malfunctions, unplug it for 3 seconds, then plug in again.
- Remove batteries if the unit is not used for extended periods.

DENVER®

www.denver-electronics.com

CE



Electric and electronic equipment and included batteries contains materials, components and substances that can be hazardous to your health and the environment, if the waste material (discarded electric and electronic equipment and batteries) is not handled correctly.

Electric and electronic equipment and batteries is marked with the crossed out trash can symbol, seen below. This symbol signifies that electric and electronic equipment and batteries should not be disposed of with other household waste, but should be disposed of separately.

As the end user it is important that you submit your used batteries to the appropriate and designated facility. In this manner you make sure that the batteries are recycled in accordance with legislature and will not harm the environment.

All cities have established collection points, where electric and electronic equipment and batteries can either be submitted free of charge at recycling stations and other collection sites, or be collected from the households. Additional information is available at the technical department of your city.

Hereby, Inter Sales A/S declares that the radio equipment type CRL-341 is in compliance with Directive 2014/53/EU. The full text of the EU declaration of conformity is available at the following internet address: www.denver-electronics.com and then click the search ICON on topline of website. Write model number: crl-341
Now enter product page, and red directive is found under downloads/other downloads

Operating Frequency Range:88-108MHz
Max Output Power:5W

Imported by:
DENVER ELECTRONICS A/S
Omega 5A, Soeften
DK-8382 Hinnerup
Denmark
www.facebook.com/denverelectronics